

## Kopfgescheit KG637 Kit – Automatic Urinal Flush System

The core component of this kit is a siphon with an integrated fluid-flow sensor and automatic control unit Kopfgescheit KG-A419 (patented).

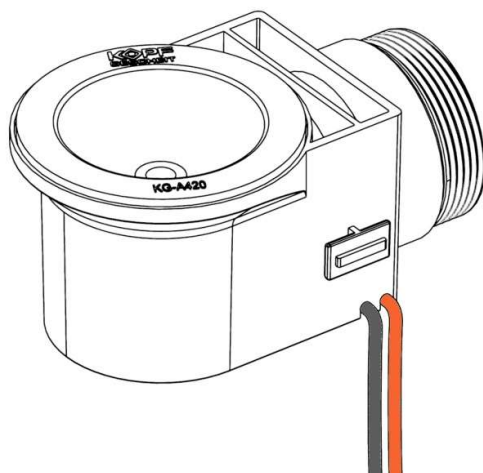

In addition to performing standard water trap functions, this siphon monitors liquid flow through a built-in contactless sensor. It replaces the standard siphon and is manufactured from plastic (Polypropylene, PP).

When urinal use begins, a short pre-flush occurs; after usage ends, the main flushing sequence initiates automatically.

For installation in stainless steel urinal bowls, it is recommended to prepare drainage holes and a central hole for an M6 stainless steel screw (AISI304).

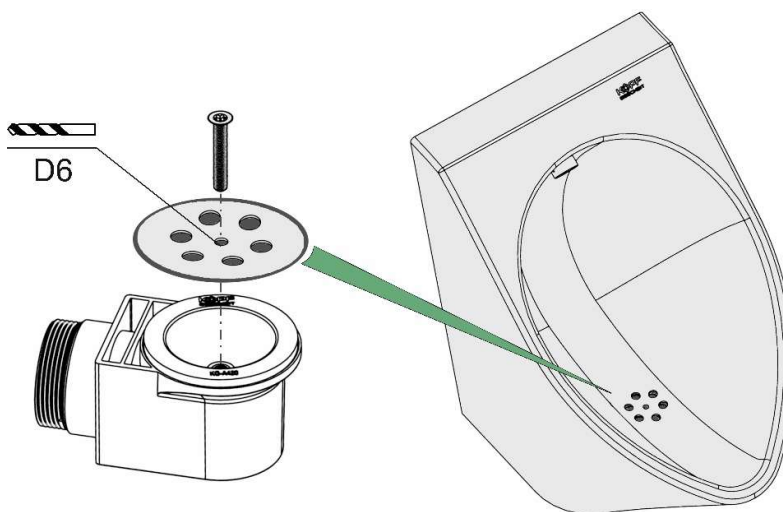

The siphon is secured with this screw, which engages a brass insert within the siphon. To prevent unauthorized removal, it is recommended to use a thread-locking adhesive (e.g., type 243), which can be included in the supply package.

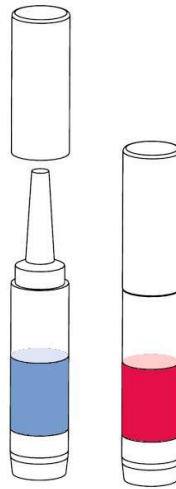

The siphon connects to the drainage system via a standard sewer pipe (Ø50 mm) or a flexible corrugated pipe KG-A300D (Ø40 mm).

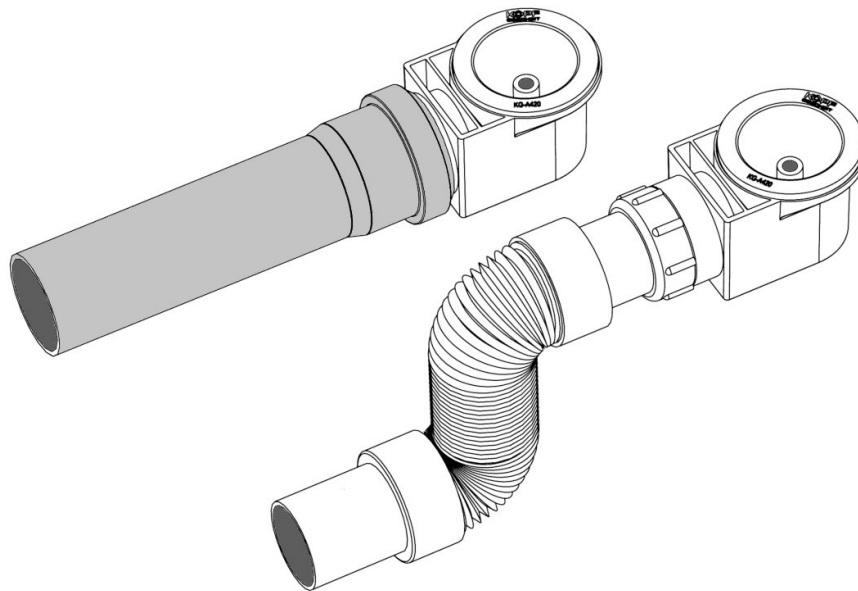

The automatic control system is powered by four standard AA batteries housed in an IP65-rated battery compartment KG-A415 attached to the siphon side. A set of quality alkaline batteries typically powers the unit for approximately one year.

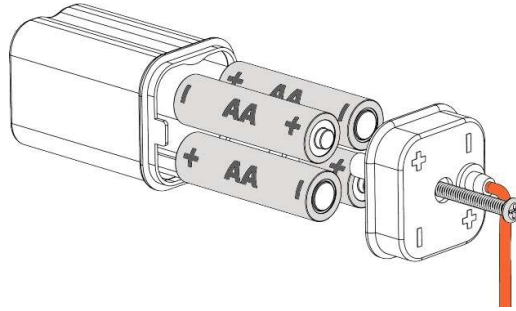

External power from any USB 5V source can also be used,

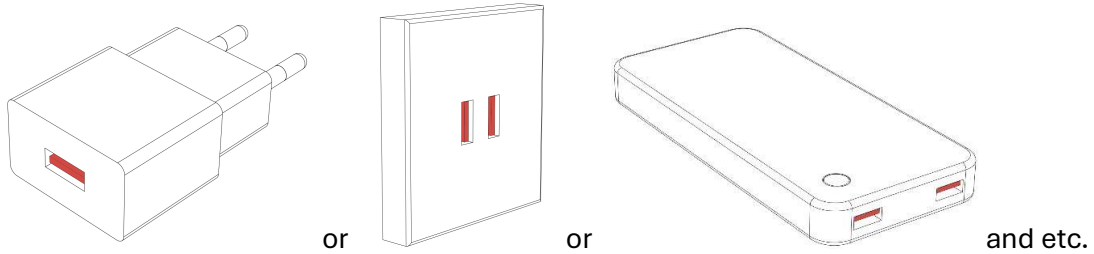

with the KG-A312 USB power cable included in the kit.

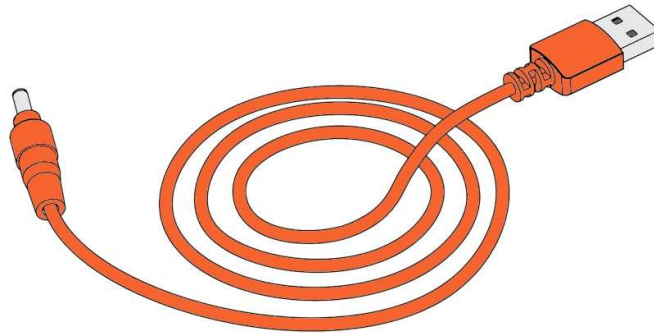

The bowl flushing is performed using the urinal's built-in flush mechanism. If no suitable flush system is available, the kit can be supplemented with a stainless steel (AISI304) rinser KG-A217D.

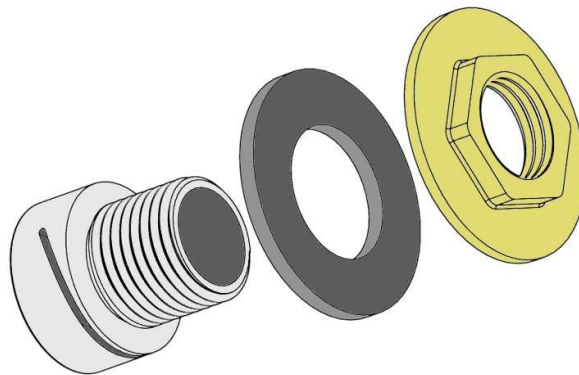

The nozzle shape is optimized to suit most urinal bowl designs.

Water connection to the rinser is via stainless steel corrugated tubing (AISI304, wall thickness 0.3 mm) KG-A392.

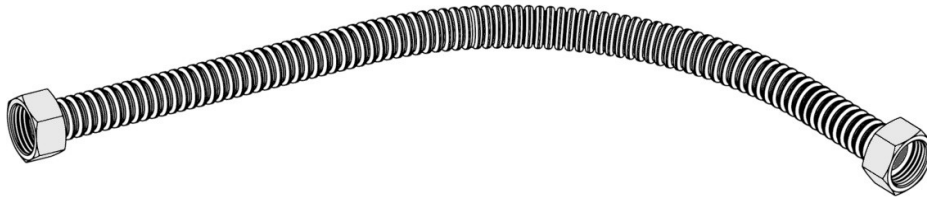

A bistable solenoid valve controls water supply for flushing.

Available valve configurations:

Plastic (PP) solenoid valve without flow regulation KG-A232

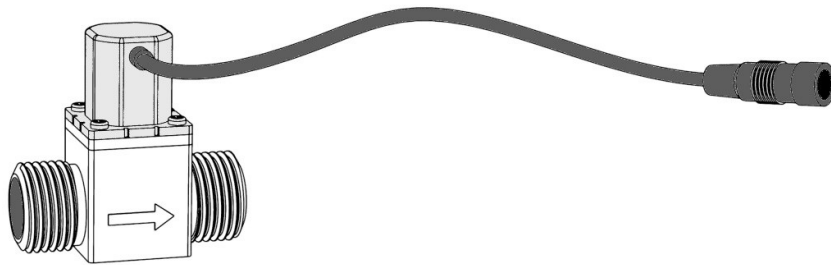

Angled brass valve (LS59-1 low-lead brass) with flow regulation and integrated 100-micron filter, featuring easy maintenance without disconnecting external water supply KG-A315.

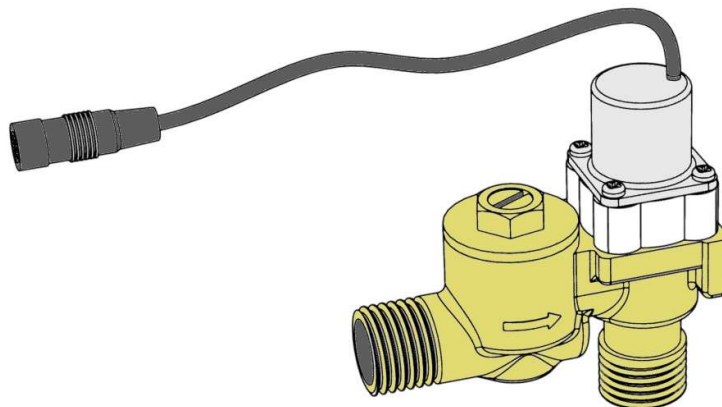

Straight brass valve (LS59-1 low-lead brass) with flow regulation and integrated 100-micron filter, offering easy maintenance without disconnecting external water supply KG-A31.

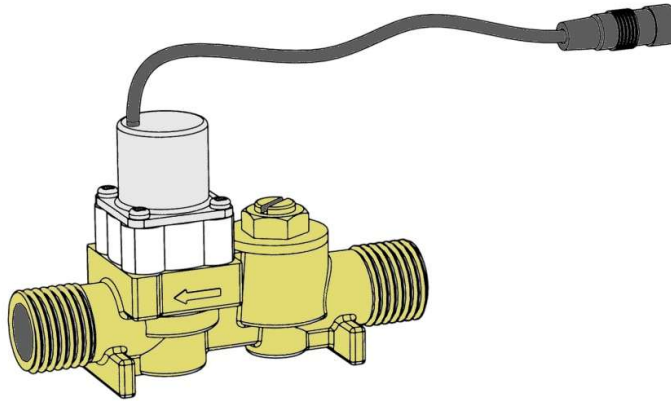

Pricing for **Kopfgescheit KG637 Kit** (Basic Configuration - Plastic Valve):

1. Siphon with automatic control unit and fixing screw KG-A419
2. Battery compartment KG-A415
3. USB power cable KG-A312
4. Stainless steel corrugated water supply tube for valve and rinser KG-A392
5. Plastic solenoid valve KG-A232
6. Packaging, technical datasheet, caution label

Price: 55 EUR (excl. VAT).

Pricing for **Kopfgescheit KG637 Kit** (Basic Configuration - Brass Valve):

1. Siphon with automatic control unit and fixing screw KG-A419
2. Battery compartment KG-A415
3. USB power cable KG-A312
4. Stainless steel corrugated water supply tube for valve and rinser KG-A392
5. **Brass solenoid valve** (angled KG-A315 or straight KG-A31)
6. Packaging, technical datasheet, caution label

Price: 65 EUR (excl. VAT).

The kit composition and design may be adjusted to customer specifications.

This pricing offer is exclusive to urinal manufacturers for integrating into their products.

Minimum order quantity: 1000 kits annually.

**Optional accessories:**

1. Plastic corrugated pipe KG-A300D – 1 EUR excl. VAT
2. USB power adapter – 3 EUR excl. VAT
3. Stainless steel rinser KG-A217D with gasket and fixing nut – 7 EUR excl. VAT
4. Thread-locking adhesive type 243, 1 g tube – 0,5 EUR excl. VAT
5. Stainless steel corrugated flexible hose AISI304 1/2", 20 cm KG-A304.30 – 2 EUR excl. VAT
6. Stainless steel bowl KG-A300C AISI304, Ø70 mm, steel thickness 0.5 mm – 1 EUR excl. VAT

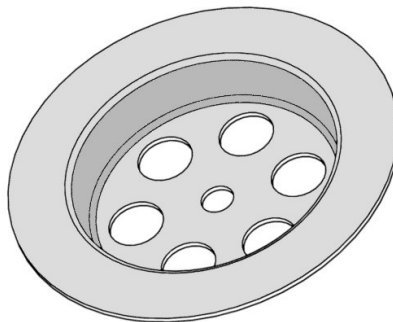

7. Angled water valve KG-A318, stainless steel AISI304 with ceramic cartridge, connection insert for water socket, and decorative cover plate AISI304 – 3 EUR excl. VAT

